



## Luxurious Family Living in a Custom-Built Home

Step into a world of luxury and thoughtful design at this stunning four-bedroom residence, the largest land offering in the Clydesdale Estate, set on a sprawling 6,000sqm and expertly crafted by Custom builder Haven just two years ago. With luxurious finishes throughout and a well-appointed floor plan, this home is perfect for modern family living.

Step outside to the undercover alfresco area, complete with ceiling fans and a fireplace, where you can enjoy year-round outdoor living. The undercover pool area and meticulously designed outdoor spaces ensure that no detail has been overlooked. The stunning lap pool, set against a backdrop of exposed salt and pep

**Luke Moloney**

0447 780 999

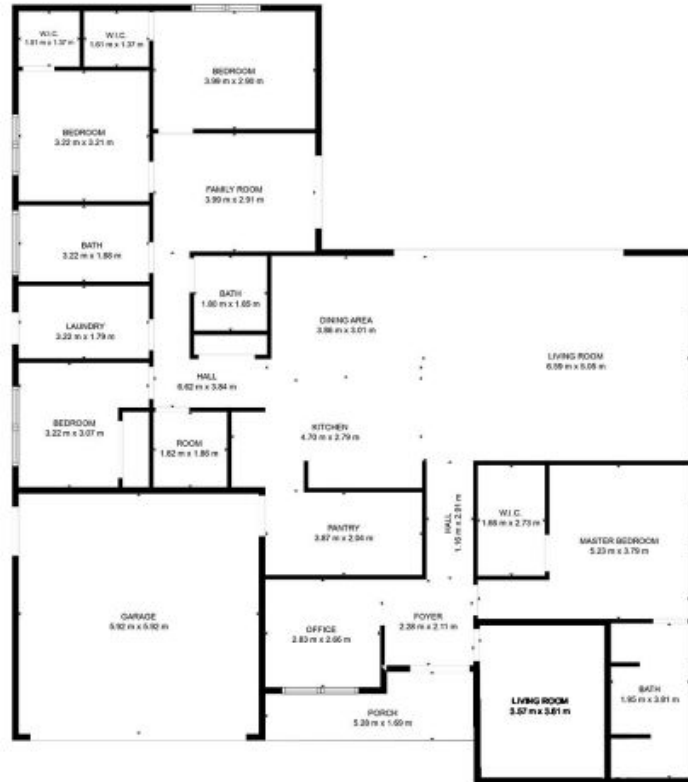

**TOTAL: 187 m<sup>2</sup>**  
**FLOOR 1: 187 m<sup>2</sup>**  
**EXCLUDED AREAS: GARAGE: 35 m<sup>2</sup>, PORCH: 7 m<sup>2</sup>**

SIZES AND DIMENSIONS ARE APPROXIMATE, ACTUAL MAY VARY.

**Moloney**  
 REAL ESTATE

**5 Clare Court**

**Rutherglen, VIC**

**Moloney**  
 REAL ESTATE