



## Impressive from the moment you arrive

This classic red brick home exudes warmth and charm, offering an inviting sanctuary in a prime location. With its timeless exterior and thoughtful interior design, this beautiful property is as practical as it is picturesque. The home's spacious layout and light-filled rooms make it ideal for family living and entertaining, providing both comfort and style in equal measure.

Additionally, a large shed/workshop with a substantial roller door is accessible from both the backyard and a separate street entry - perfect for securely storing a boat or even large caravan. The property is completed with a

**Luke Moloney**

0447 780 999

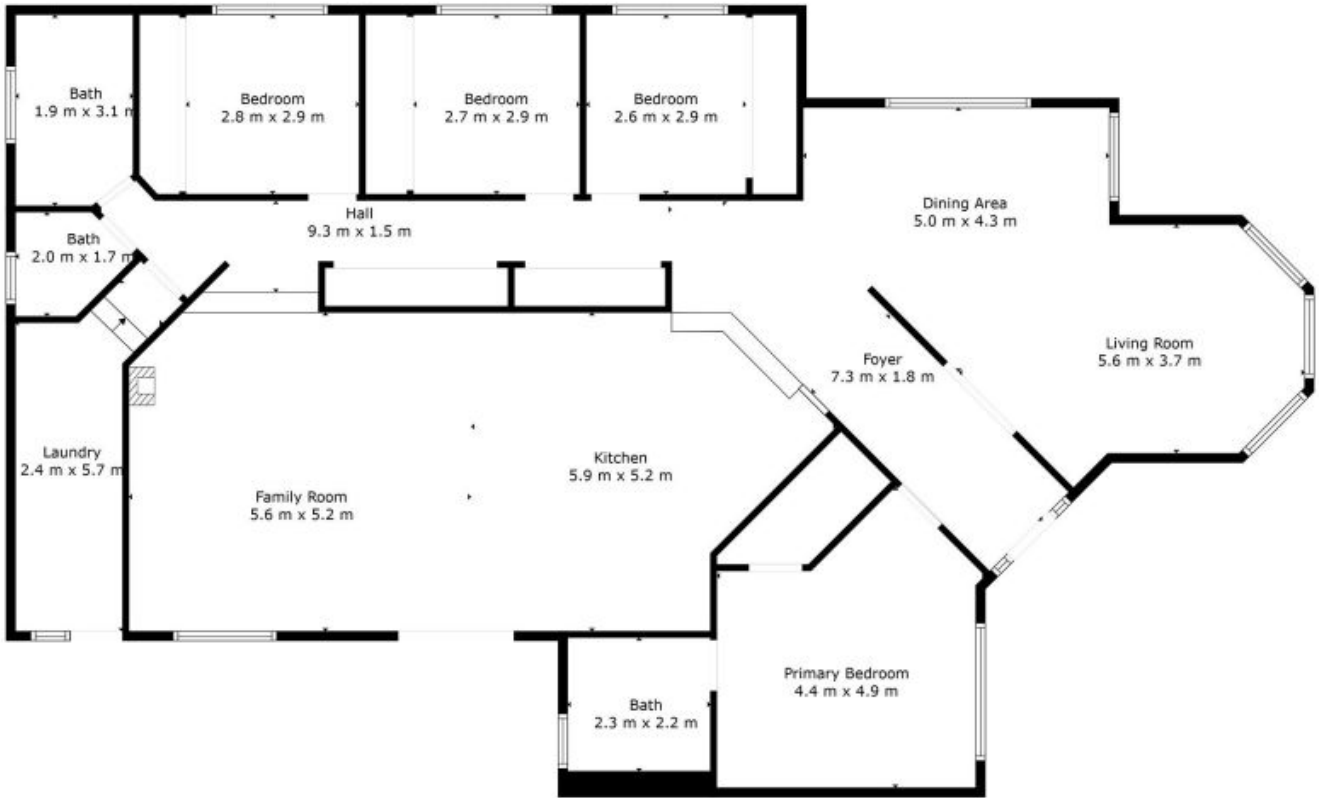

**TOTAL: 194 m<sup>2</sup>**  
**FLOOR 1: 194 m<sup>2</sup>**

Floor Plan Created By Cubicasa App. Measurements Deemed Highly Reliable But Not Guaranteed.

**Moloney**  
REAL ESTATE

**1 Morley Drive**

**Wahgunyah, VIC**

**Moloney**  
REAL ESTATE